



201 Grandin Road
Maineville, Ohio 45039
(513) 677-0500

Manual Drawer (MD) Customer Door Arm Replacement Manual

Table of Contents

| | |
|--------------------------------|---|
| Tool and Parts List | 1 |
| Installation Instructions..... | 1 |
| Figure 1 | 3 |
| Figure 2 | 4 |

Tools Needed:

5/16” Wrench or Nut Driver
Flat Blade Screwdriver
Loctite 242 (Blue) Thread Locker

Parts: Supplied

1 Set – Customer Door Arms
2 – 3/8” “E” Clip
4 – 3/8” Flat Washers
1 – Tube of Grease

Installation Procedure:**Replacing the Customer Door Arms**

Run the drawer out, and then, from the customer end of the Drawer, use a flat blade screwdriver to remove the (2) “E” clips at the pivot end of the Arms and the outer Flat Washers, (see Fig. 2).

Gently bow the Arms outward until they clear the end of the Pivot, and then remove the Customer Door and Arm Assembly from the Red Bin Assembly.

Place the Customer Door on a surface that will not damage the front face.

Using a 5/16” Wrench or Nut Driver, remove the (6) 8-32 Acorn Nuts that secure the Arms to the Door.

Install the new Arms in place with the long sloped edge to the bottom of the Customer Door.

Place a drop of Loctite 242 on each of the studs and install and tighten the 8-32 Acorn Nuts.

Wipe off the arced edge, and the bottom of the Arms near the back of the Customer Door and apply a thin film of the Grease provided.

Wipe off and lube the hole for the pivot, and apply a thin film on both sides of the Arms, the Pivot hole, and where the Flat Washers will contact the Arm.

Re-installing the Customer Door and Arm Assembly

Inspect the 3/8” Flat Washers for wear, rust, corrosion and damage and replace if necessary. (Note: For proper Door alignment there should be one Washer inboard and one Washer outboard of each Arm.)

Gently bow out the Customer Door Arms and place over the.

Install the outer 3/8” Flat Washer and new “E” Clip on each side.

Clean the top outer 2-3” of the plastic Guide Track on both sides of the Drawer.

Apply a small amount of Grease to the top outer corner of the Guide Track where the Customer Door Arm will slide, and the curved part of each Customer Door Arm.

(Note: It is highly recommended that the remaining slide points be wiped clean and lubed with the remaining Grease as per Fig. 3.

Test operation.

Verify that the Customer Door opens and closes freely and fully. Check to see that the Door Gasket seats against the outer edge of the Drawer Shell and that the Lock works.

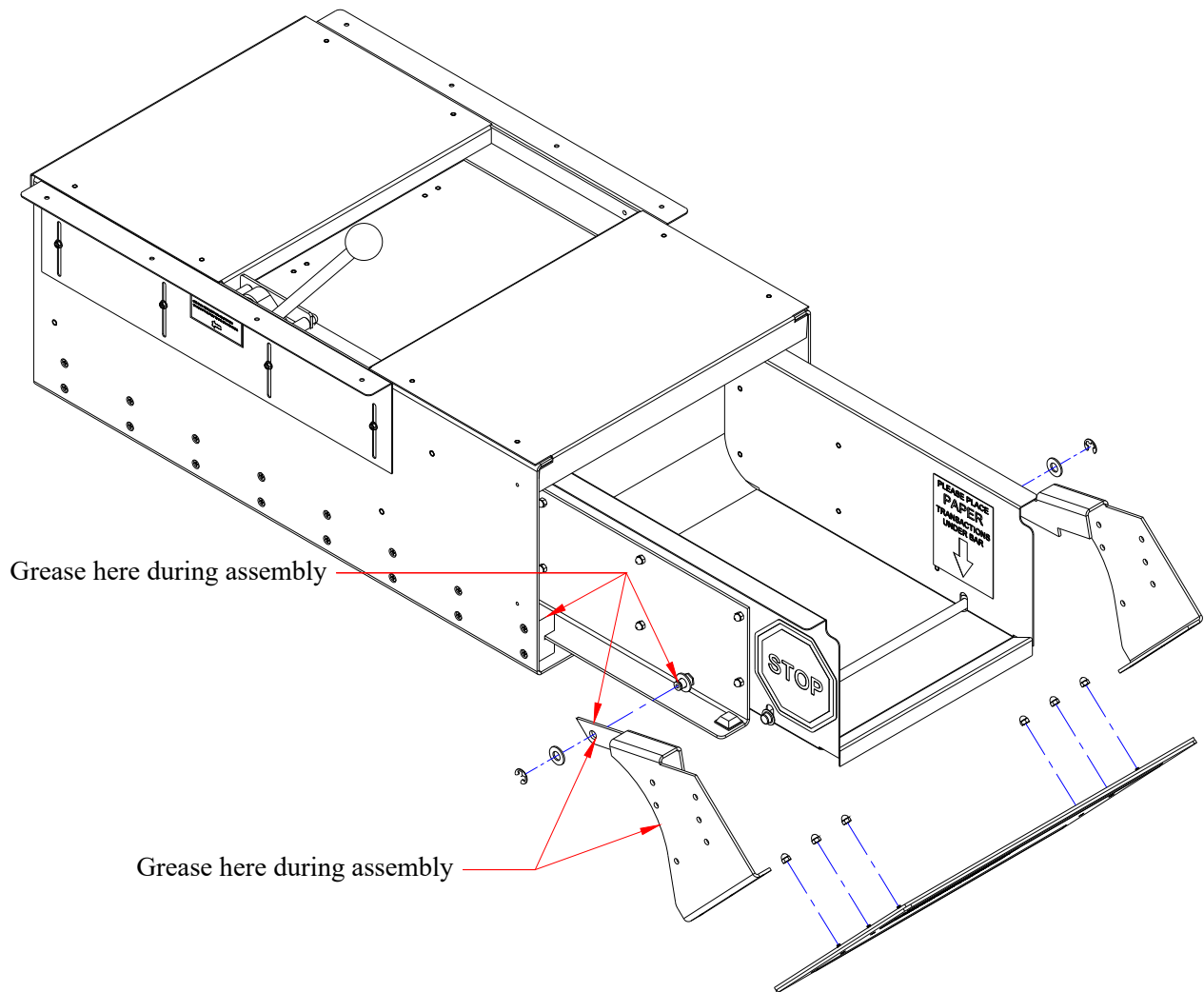
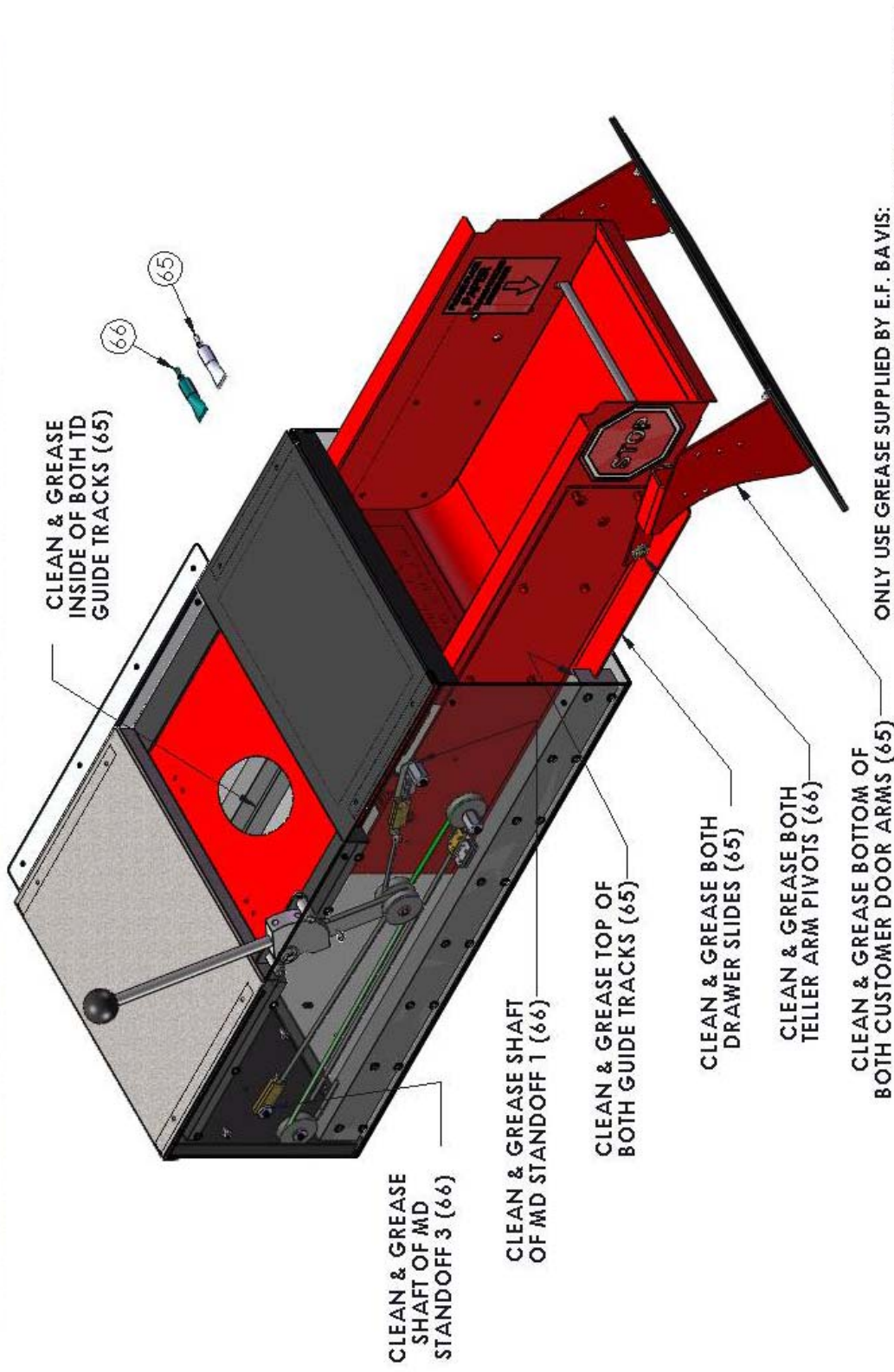

Fig 1

BAVIS MANUAL DRAWER CLEANING AND LUBRICATION INSTRUCTIONS



- ONLY USE GREASE SUPPLIED BY E.F. BAVIS:
P/N 04115011 (CLEAR), P/N 04191011 (BLUE/GREEN) OR P/N:
13041991 MANUAL DRAWER GREASE KIT.
- DO NOT CLEAN WITH SOLVENTS.
 - WIPE DOWN ALL AREAS WITH A CLEAN DRY CLOTH PRIOR TO APPLYING GREASE.
 - DO NOT USE: WD-40, OIL, GRAPHITE, TEFLON, DRY LUBES, OR OTHER LUBRICANTS NOT SUPPLIED BY E.F. BAVIS.

Fig 2

