



201 Grandin Road
Maineville, Ohio 45039
(513) 677-0500

Manual Transaction DrawerTM

Installation and Service Manual

Copyright 2018 E. F. Bavis & Associates, Inc.
All Right Reserved

Revised: 10/15/2018
PN: 00636011

Manual Transaction Drawer™

Table of Contents

Features	1
Installation/Service Information	2
Troubleshooting	3
Exploded Parts Diagram	4
Cable Routing Diagram	5
Parts List	6
Installation Dimensions	7

Features

The *Manual Transaction Drawer™* is a reciprocating conveyor system for use in package passing applications. Burglary, theft protection and bullet resistant features have not been evaluated. The conveyor is designed to extend from the inside to the outside of a facility.

Adjustable stainless steel flanges are provided for mounting. The flanges can be adjusted from 1-1/2" above to 1" below the top of the drawer. Please refer to page 7 for installation dimensions. **Note: Use maximum 3/8" long screws to prevent jamming. 8-32 x 3/8" thread forming screws provided.**

The drawer weighs less than 150 lbs. and can be shipped UPS to most locations.

A night latch is provided.

The drawer is constructed of heavy 11 gauge steel with a durable powder coated finish. Note that the top inside panel is made from stainless steel. Its large 25 pound capacity is suitable for commercial or convenience store transactions.

The bin of the drawer is powder coated with a bright red finish and features a stop sign decal that is visible when the drawer is open. The drawer color and stop decal are designed to warn customers not to approach when the drawer is open.

Full 15" extension of drawer.

Full width bill/paper trap bar.

No wiper or sliding type weather seals. Our seals are replaceable and operate in compression to reduce wear and provide the best possible protection from the elements.

There are no roller type drawer guides, which are easily jammed with paper clips and coins. The drawer guides are manufactured from a High-Tech lubricated material designed and built specifically for this application.

No belts or gearboxes are used. The *Manual Transaction Drawer™* features a quiet, self-adjusting, cable drive that allows the drawer to travel approximately twice the distance the lever is moved.

No fuses to replace.

An optional customer audio panel with speaker, microphone and 1 call button, Part # 00539992, is available.

Installation and Service Information

Customer Door Removal

To make installation of the *Manual Transaction Drawer*[™] easier from the inside, it is possible to remove the customer door. Run the drawer out until the teller door is closed and the customer door pivot posts are exposed. Carefully remove the "E" clips and washers from each side. Take the arms off of the pivot posts by gently spreading the customer door actuator arms outward until they clear the pivot posts. Remove the customer door. Reverse the steps to reinstall the customer door. **Note that there should be one washer inside and one washer outside of each arm before reinstalling the "E" clips.**

The Customer Door Seal works best if the *Manual Transaction Drawer*[™] is installed so that the gasket on the customer door contacts the drawer's outer shell first, before contacting the supporting wall or audio panel.

Servicing the Inside of the Drawer

Access to the inside of the drawer is through the back (Figure 1). There are three screws on the face and two on the bottom that hold the back panel in place. After removing the screws, tilt the bottom of the back panel out, then drop it down to clear the lip of the top panel. Reverse this procedure to reinstall the back panel.

Figure 1

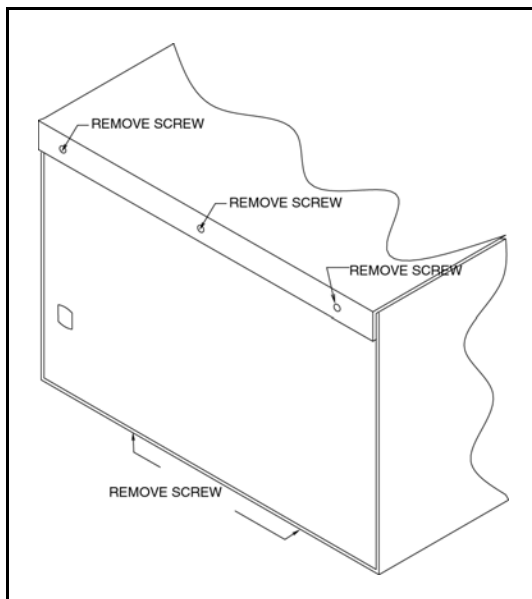

Drawer Removal

To remove the drawer it is necessary to disconnect the drawer to cable bracket from the right side of the drawer. There are (2) #8-32 machine screws that have to be removed. After the screws are removed, remove (4) #6-32 nuts that connect the teller door actuator to the drawer bin. Move the drawer out until the actuator can be disconnected from the drawer bin. The drawer can be slid out from the outside.

Reinstalling the drawer is as simple as sliding the drawer back into position and reversing the above procedure.

Troubleshooting

Drawer won't work.....

Check for damage to drawer.

Check cable routing, (see page 5)

Is the drawer jammed? If the drawer is jammed, correct the problem.

Drawer won't run out...

Check night latch, set to unlock.

Drawer won't close fully...

Check that night latch is set to unlock.

Check for damage to drawer.

Check for object between customer door and shell edge.

After completing the above, if a problem continues, contact qualified service personnel.

CONFIDENTIAL
THIS DRAWING IS THE PROPERTY OF E.F. BAVIS &
ASSOC. INC. IT MAY NOT BE DUPLICATED, TRANSMITTED
OR USED FOR PRODUCTION WITHOUT EXPRESS
PERMISSION OF THE OWNER.
E.F. BAVIS & ASSOC. INC. COPYRIGHT 2014

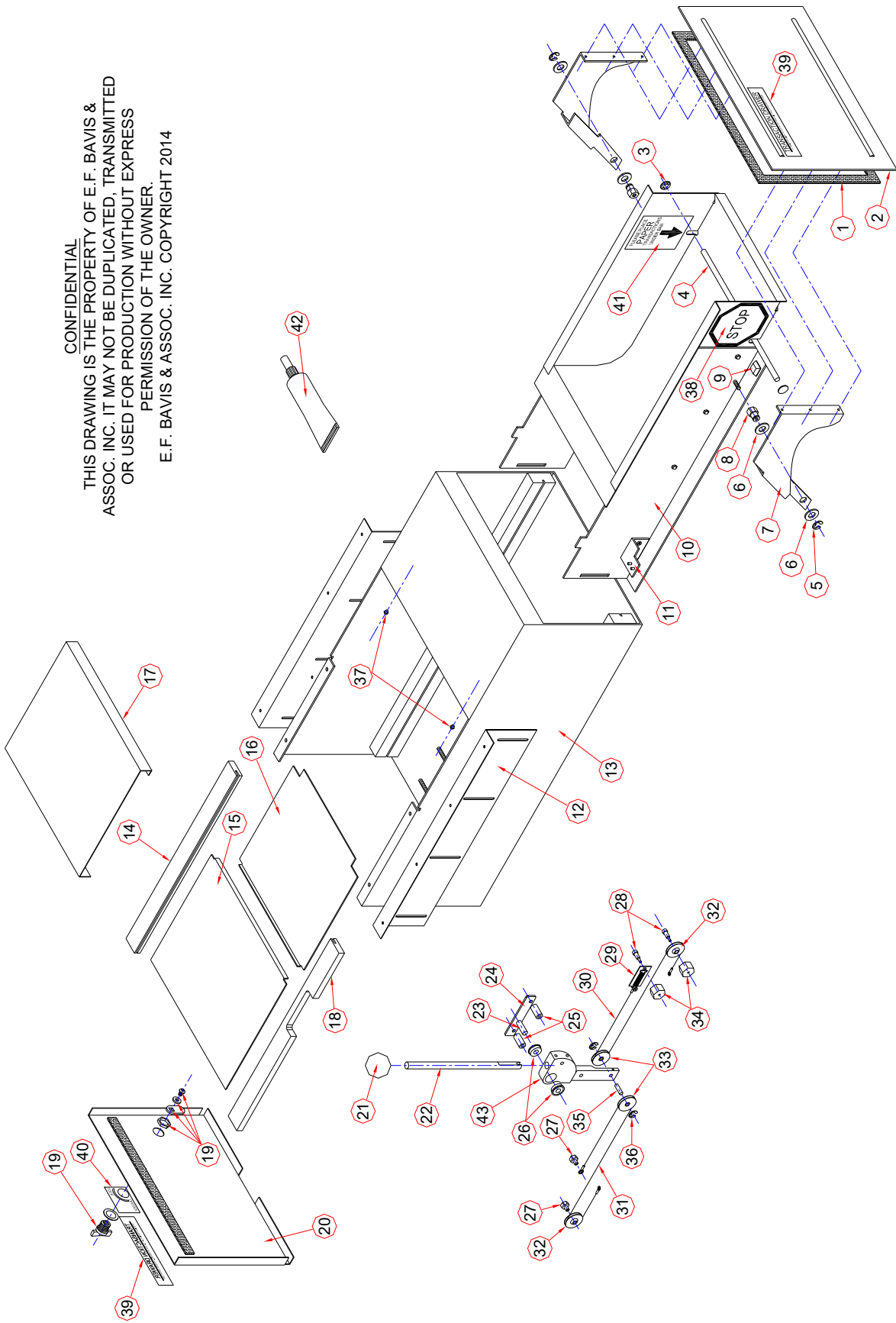

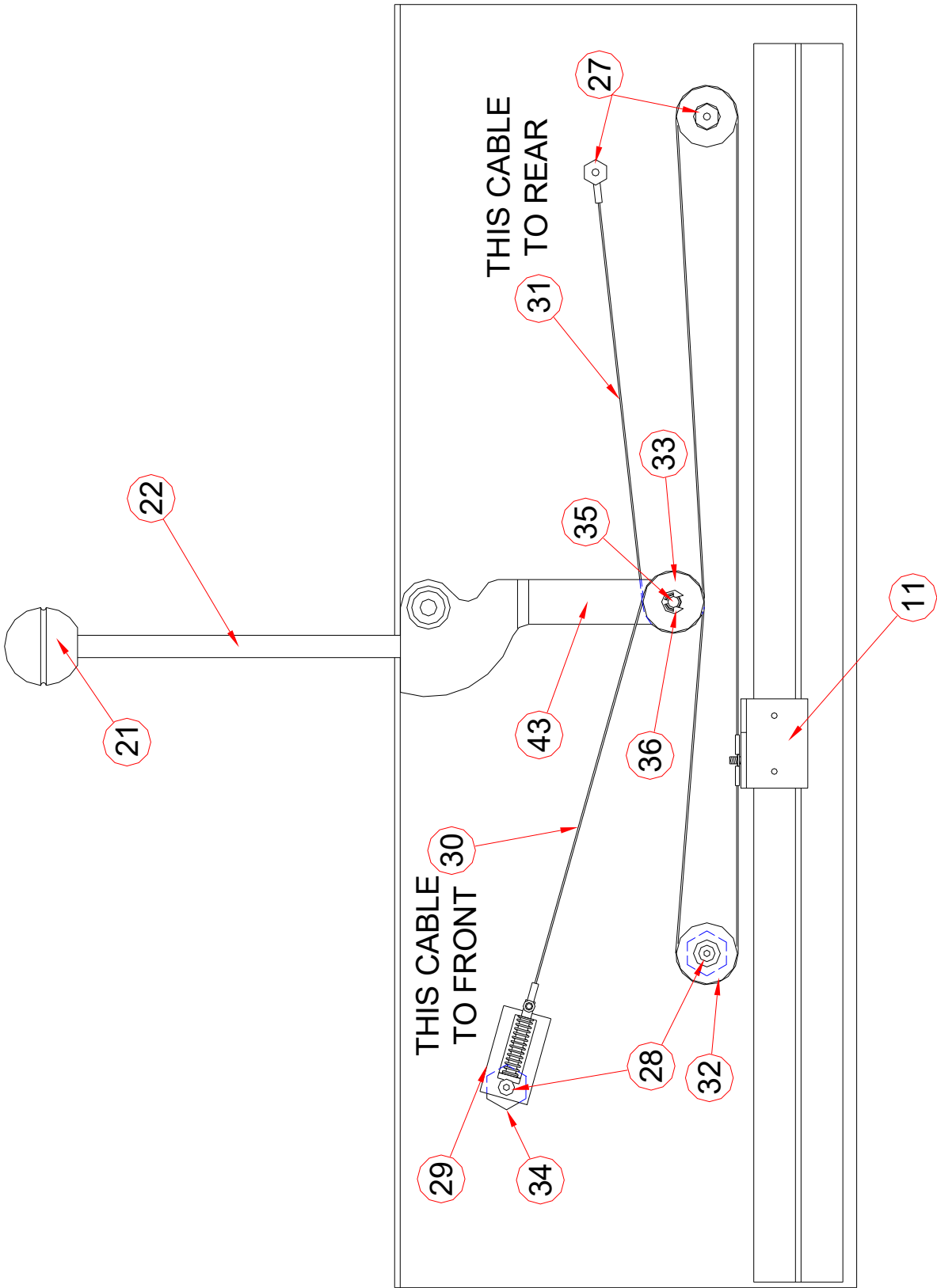

<u>ITEM #</u>	<u>PART #</u>	<u>DESCRIPTION</u>	<u>ALSO CONTAINS</u>	<u>QTY</u>
1	00529021	TD CUSTOMER DOOR GASKET		1
2	13010991	MD CUSTOMER DOOR ASSEMBLY	1,39	1
3	97000073	3/8" SS PUSH CAP		2
4	13005012	MD CASH BAR		1
5	97005071	3/8" "E" CLIP		2
6	98006000	1/2 " SAE FLATWASHER		4
7	13036991	MD CUSTOMER DOOR ARMS		2
8	00530012	MD TELLER DOOR PIVOT		2
9	02963011	STICK ON FEET		2
10	13003991	REPLACEMENT MD DRAWER RED TUB	3,4,38,41,42	1
11	13006011	DRAWER TO CABLE BRACKET		1
12	00534011	TD MOUNTING ANGLES SM		2
13	13001991	MD SHELL ASSEMBLY		1
14	13017012	MD TELLER DOOR SLIDE LEFT		1
15	13015991	MD TELLER DOOR ASSEMBLY		1
16	13016011	MD TELLER DOOR ACTUATOR		1
17	13019011	MD FRONT TOP COVER		1
18	13017022	MD TELLER DOOR SLIDE RIGHT		1
19	00592991	TD LOCK KIT		1
20	13018991	MD BACK PANEL ASSEMBLY	19,39,40	1
21	00547011	MD MANUAL KNOB		1
22	13013022	MD UPPER LEVER		1
23	13024011	MD LEVER 3/8" AXLE		1
24	13023011	MD LEVER MOUNT PLATE		1
25	13025011	1/2" O.D. X 1/4" I.D. X 1" STEEL SPACER		2
26	00141013	3/8" BEARING WITH FLANGE		2
27	13012011	MD PULLEY AXLE		1
28	95069233	1/4" X 3/8" SOCKET SHOULDER BOLT STAINLESS		2
29	13034011	COMPRESSION SPRING ASSEMBLY		1
30	13021021	MD SPRING CABLE		1
31	13021011	MD STATIONARY CABLE		1
32	04070014	CABLE IDLER PULLEY		2
33	04070015	MD LEVER CABLE WHEEL		2
34	13012021	MD PULLEY HEX SPACER		2
35	13024021	MD LEVER 1/4" AXLE		1
36	95005071	1/4" "E" CLIP		1
37	13027011	MD SMALL BUMPER		2
38	00537031	TD STOP LABEL		1
39	00558011	TD AL LOGO WITH PATENT NO.		2
40	00537041	TD LOCK LABEL		1
41	00537021	TD PLACE PAPER LABEL		1
42	04191011	BLUE / GREEN GREASE 4CC TUBE		1
43	13013011	MD LOWER LEVER		1

BAVIS TRANSACTION DRAWER DIMENSIONS

PLAN VIEW

